

PB4000 Series Parking Barrier

The PB4000 series parking barrier is an ideal automatic car park barrier for parking lot and security control.

The ZKTeco parking product range does not only offer long-life cycle, reliability and quality. Furthermore, based on the extraordinary structural design, the device has a compact size, excellent waterproof dustproof performance and low noise operation. Also it greatly reduces the difficulty of equipment maintenance that effectively reduces the operation cost of the user.

Features

- The modularly designed housing made of powder coated steel offers best protection against corrosion.
- The compact structure design is convenient for packing and saving transportation cost.
- Simple installation; it is only necessary to screw the equipment on the ground and connect the electricity.
- Abundant production strength, provide mass customization service.

Specifications

Model No.	PB4030L/R	PB4060L/R
Lane width	4m	6m
Opening / closing time	3s	6s
Supply voltage	110V AC or 220V AC	110V AC or 220V AC
Power consumption max.	120W	120W
Frequency	50-60Hz	50-60Hz
Cabinet material	powder coated steel	powder coated steel
Boom material	aluminum alloy	aluminum alloy
Temperature range	-20°C~+60°C	-20°C~+60°C
Humidity range	≤90%	≤90%
Housing dimensions (W x D x H)	328 * 286 * 934(mm)	328 * 286 * 934 (mm)
Packing dimensions (W x D x H)	460 * 420 * 1150 (mm)	460 * 420 * 1150 (mm)
Net weight (without boom)	60kg	60kg
Gross weight (without boom)	70kg	70kg

Dimensions

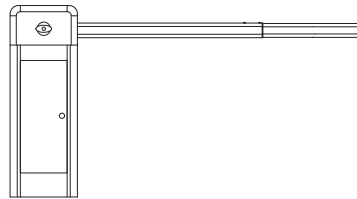
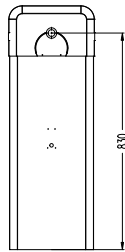
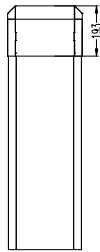
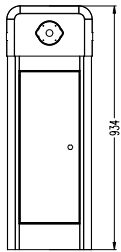
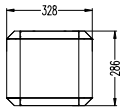

L: Cabinet on left side

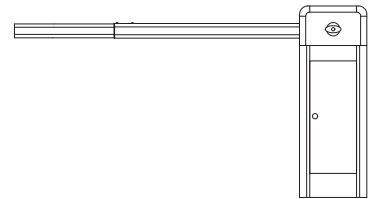

R: Cabinet on right side

Typical Installation

